

Prisoners of War and Their Treatment During the American Civil War



Exchange vs. Parole



Prisoners of War

	Union Soldiers	Confederate Soldiers
Exchanged/ Paroled	152,015	329,963
POW	210,000	220,000
Deaths	22,600	26,500

Dix-Hill Cartel

22 July 1862

MG John A. Dix (USA) MG D. H. Hill (CSA)

Sporadic – “acts of humanity”

11 Dec 1861 – US Congress resolution - “systematic measure for exchange of prisoners”

War of 1812 arrangement used as model (F. S. Key)

Dec 1862 - 1st problems – Pres. Davis suspends parole of Union officers after Gen Benjamin Butler orders execution of N. O. citizen.

Apr 1864 – Gen Grant halts all exchanges

Feb 1865 – Grant recommends exchanging 3,000/week with preference to disabled troops since few “will be got in the ranks again.”

Dix-Hill Cartel

Rank	Cartel
Private	1
SGT	2
1LT	4
CPT	6
MAJ	8
LTC	10
COL	15
BG	20
MG	40
GEN	46

Dix-Hill Cartel

Rank	Cartel	1863 pay	2008 pay
Private	1	1	1
SGT	2	1.8	2.1
1LT	4	8.1	2.5
CPT	6	8.8	3.5
MAJ	8	13.0	5.0
LTC	10	14.0	5.4
COL	15	16.3	6.5
BG	20	24.2	7.9
MG	40	35.2	8.9
GEN	46	58.3	11.7

Alton Prison

Camp Chase

Camp Douglas

Camp Randall

Elmira

Fort Delaware

Fort Jefferson

Fort McHenry

Old Capitol Prison

Point Lookout

Rock Island

Andersonville

Camp Sumter

Belle Isle

Cahaba Prison

Castle Morgan

Camp Ford

Castle Pinckney

Charleston harbor

Castle Thunder

Richmond

Danville Prison

Libby Prison

Salisbury Prison

Prison Types

Coastal fortifications

Existing jails

Old buildings

Barracks enclosed by high fences

Tent cities enclosed by high fences

Simple stockades

Prison Types

Coastal fortifications



Ft. Delaware
Ft. McHenry & Ft. Jefferson



Prison Types

Coastal fortifications

Existing jails



Prison Types

Coastal fortifications

Existing jails

Old buildings



Old Capitol

Libby Prison

Prison Types



Johnson's Island, OH

Elmira NY

Barracks enclosed by high fences

Tent cities enclosed by high fences

Point Lookout, MD



THIS IS A RECONSTRUCTION OF THE SOUTHWEST CORNER OF THE CIVIL WAR PRISON PEN. THE ORIGINAL WALL ENCLOSED APPROXIMATELY 20 ACRES. THE CONFEDERATE PRISONERS LIVED IN TENTS AND SHACKS LOCATED ON THE INSIDE OF THE PRISON PEN. THE UNION PRISON GUARDS WATCHED OVER THE CONFEDERATE PRISONERS BY WALKING AROUND THE RAISED WALKWAY LOCATED ON THE OUTSIDE OF THE FENCE.

MORE INFORMATION CAN BE FOUND AT THE VISITOR CENTER AND CIVIL WAR MUSEUM, LOCATED IN THE CAMPING AREA OF THE PARK.

RECONSTRUCTED BY: FREDERICK COMMUNITY COLLEGE AND MARYLAND FOREST, PARK AND WILDLIFE SERVICE.

Prison Types



Simple stockades

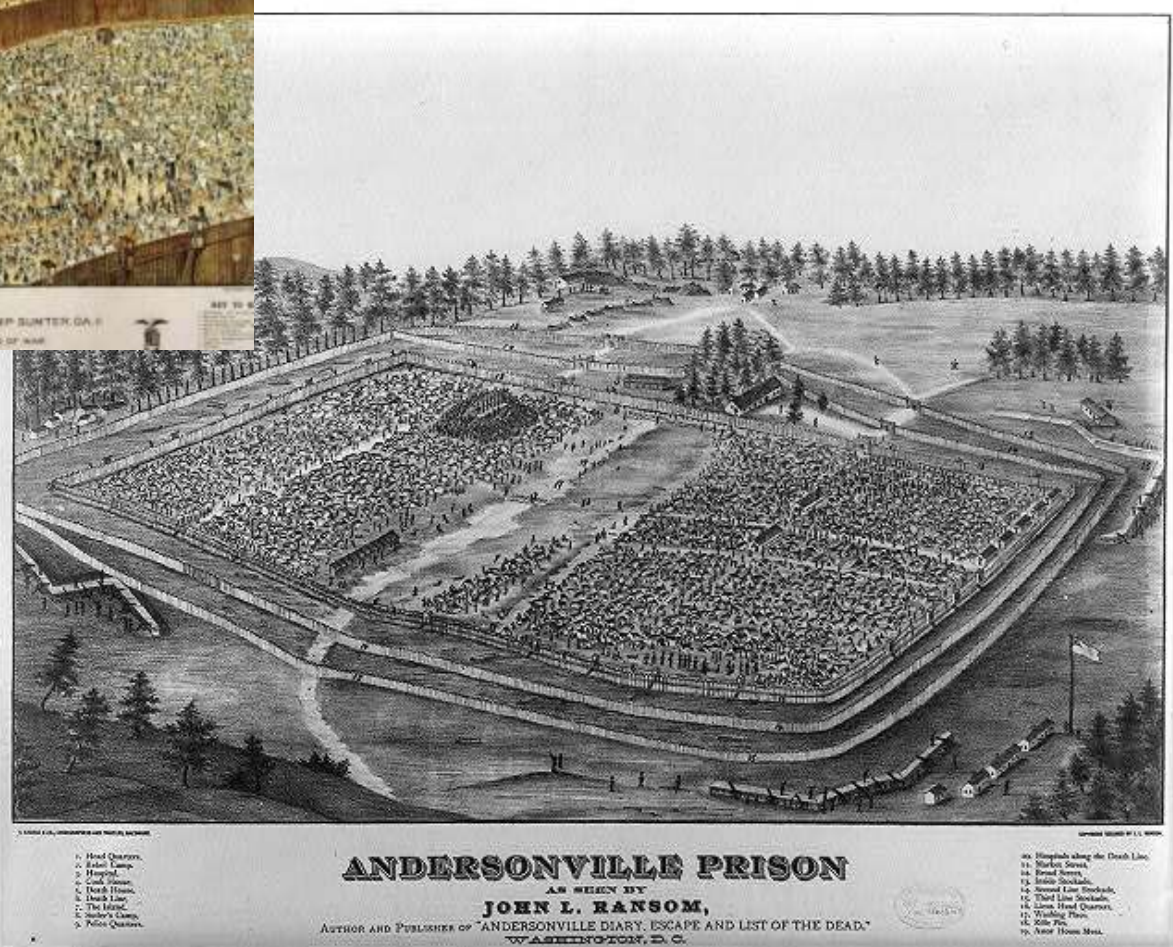

6 Pages (628-632, 733)

Mentions: Andersonville, GA
Belle Isle, VA
Salisbury, NC
Danville, VA
Libby, VA
10 others

Camp Chase, OH
Johnson's Island, OH
Point Lookout, MD
Elmira, NY
6 others

2 1/2 times as much space on southern prisons

“polluted water from only source, the trickling flow of Providence Spring”
(INCORRECT)

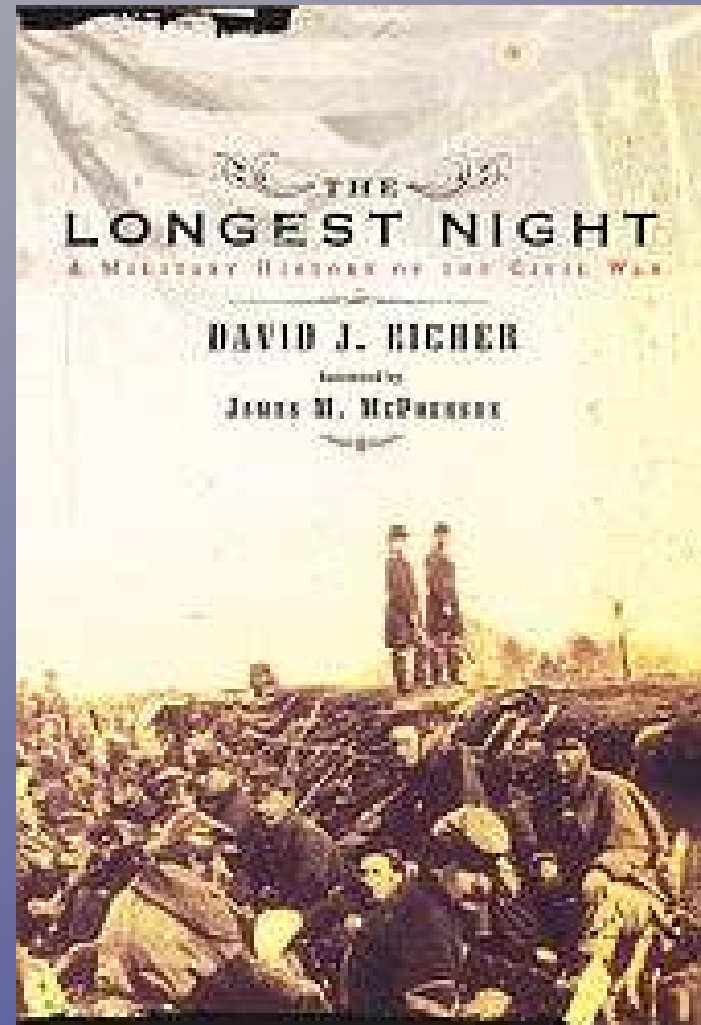

On Aug 9, 1864, a spring burst forth during a heavy summer rainstorm - an occurrence attributed to Divine Providence

Cahaba Prison, Alabama "Castle Morgan"

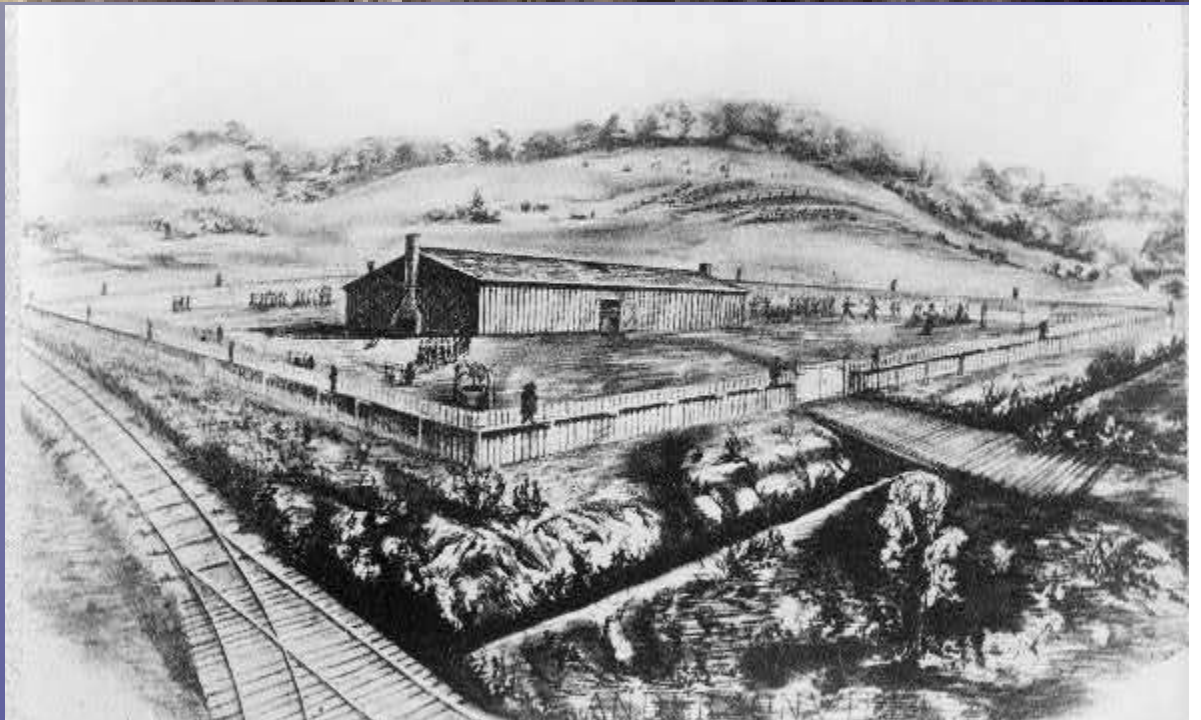
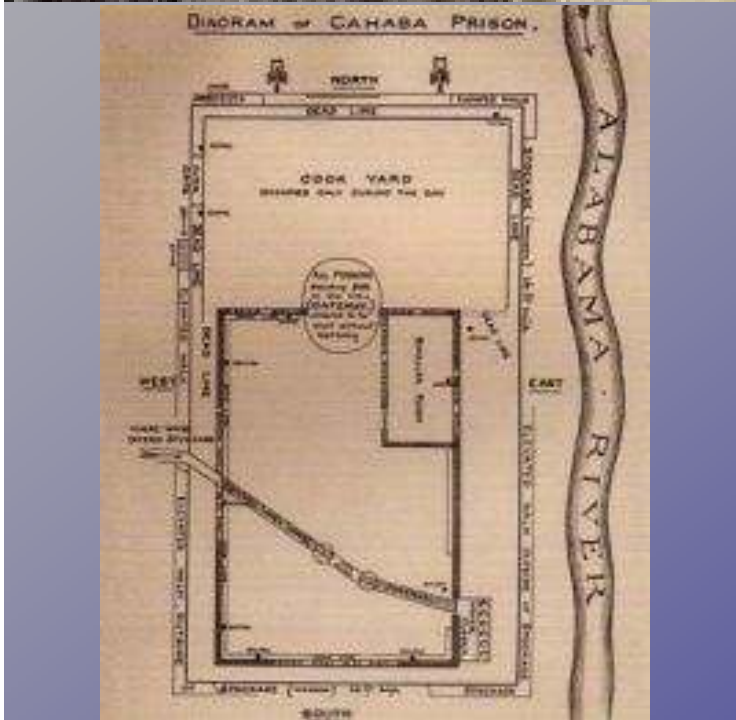
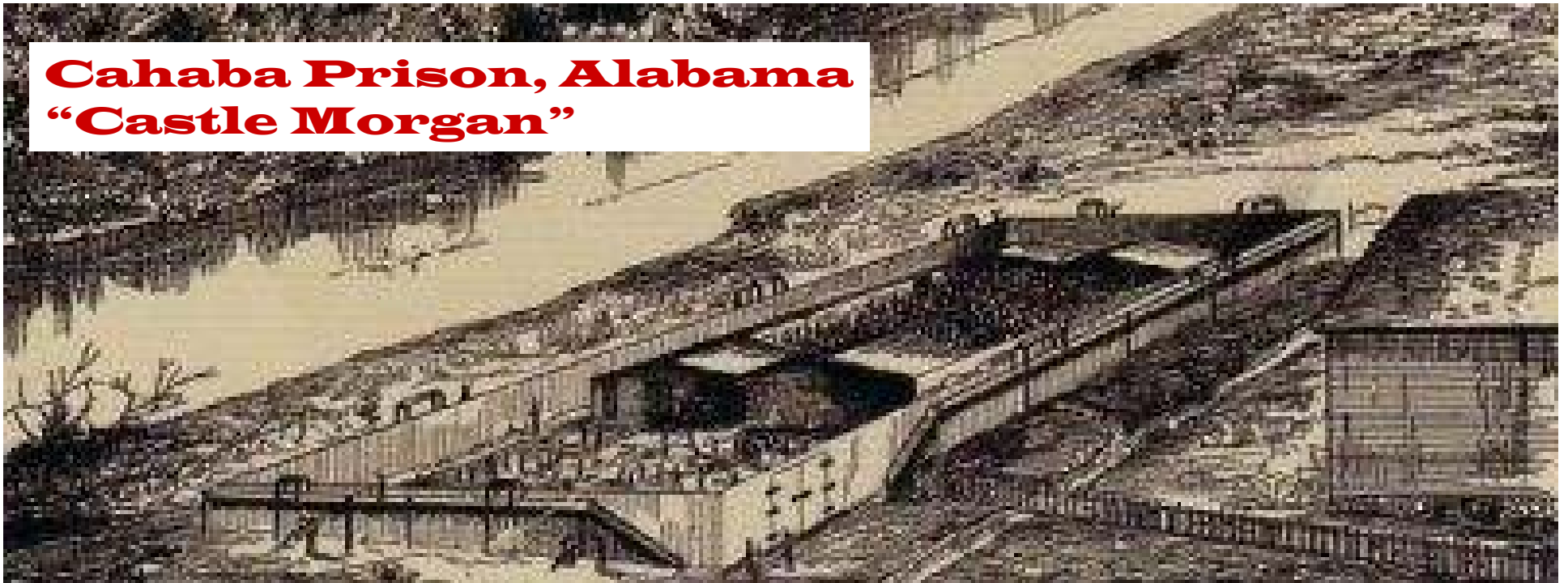

Cahaba Prison, Alabama “Castle Morgan”

Cahaba was the capital of Alabama (1820-25)

Lafayette's visit (3 days) Vine & Olive Colony

Castle Morgan

(John H. Morgan had recently escaped from Ohio Ste. Penitentiary)

15,000 sq. ft.

Bunks for 432

Population 3,000 (max)

6 sq. ft. at night / 12 sq ft. in day
(Andersonville ~ 35 sq. ft./prisoner)

5% death rate (1/3 of average)

CPT Henry Wirz

Swiss Physician / Private / Wounded

**“Only man tried, convicted
and executed for war crimes
during the Civil War.”**

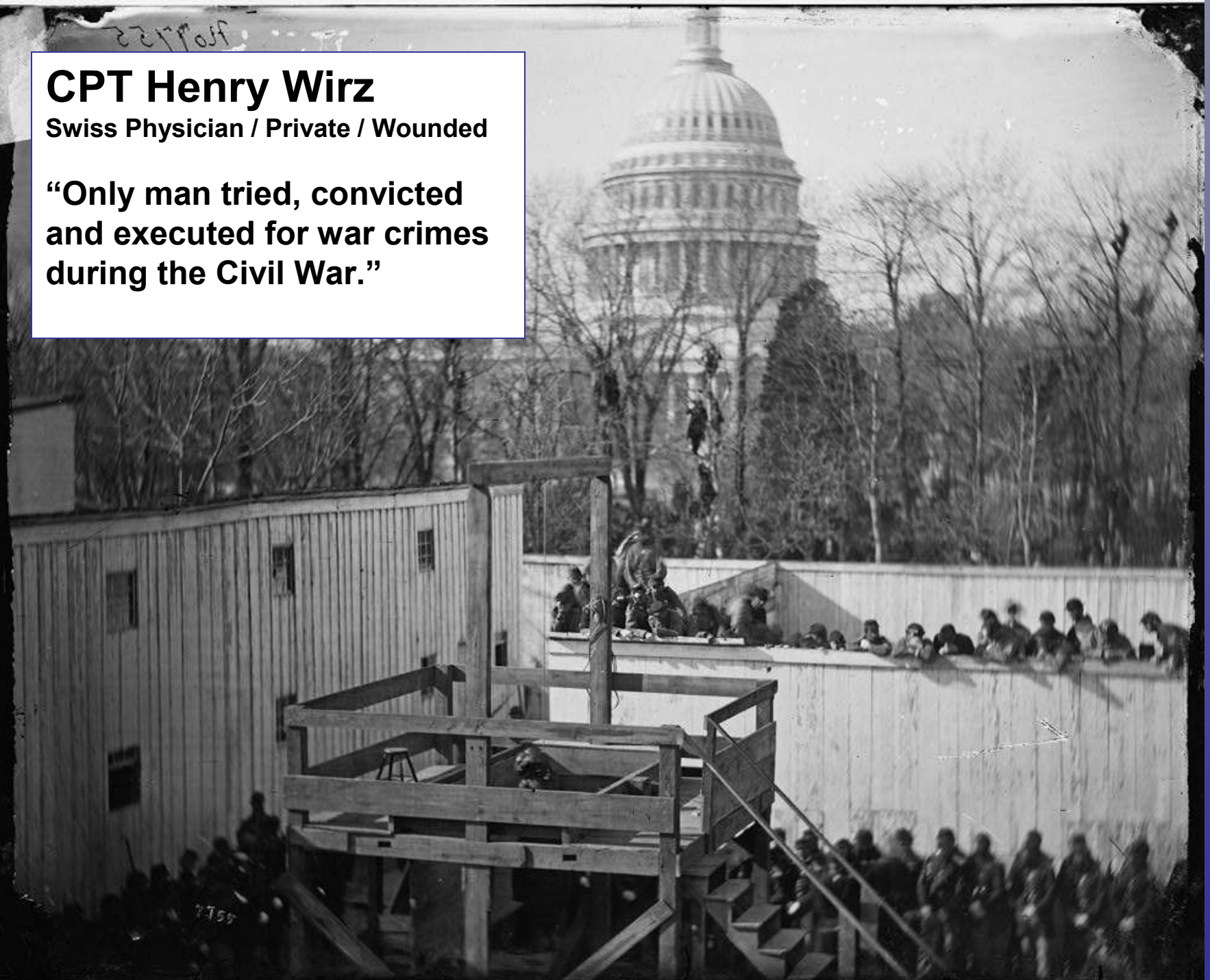

We cherish his memory here.

***We commend his spirit to God
who gave it.***

***And consign his body to the
earth whence it came.***



*Confederate Monument, Columbus, Ohio
2260 Confederate soldiers of the war of 1861-1865
buried in this enclosure*



**Prisoners of War
and Their Treatment
During the American Civil War**

**Questions
And
Comments**